

# LPM 510A/LPM 510B - SUBMINIATURE LOAD CELLS

Model LPM 510 (compression only) subminiature load cell is designed to measure load ranges from 1000 grams to 1000 pounds with a high frequency response rate. The subminiature dimensions, including diameters from 0.38" to 0.75" and Heights of 0.13" to 0.25" allow these units to be easily incorporated into systems having limited space. A small (1.0" long x 0.08" thick circuit board on ranges 50 g - 1000 g) is included in each load cell's lead wire cable for temperature compensation.

- TENSION/COMPRESSION
- WAFER-THIN
- UP TO 1000 LB
- HIGH/LOW TEMP. OPTION
- 1000 G TO 1000 LB
- OPTIONAL BOTTOM CABLE EXIT

NOTE: Ranges 150G to 1000G lbs only available in LPM 510A style.

## SPECIFICATIONS

LOAD RANGES:	150 g to 1000 lb
LINEARITY/HYSTERESIS:	±0.5% F.S.
REPEATABILITY:	±0.1% F.S.
MATERIAL:	Stainless Steel
TEMPERATURE RANGE:	60° to 160° F
OUTPUT:	150 g to 500 g - 15mv/v 1000 g - 1.5mv/v
BRIDGE RESISTANCE:	5 to 1000 lb - 2mv/v
	150 g to 500 g - 500 ohm 1000 g - 350 ohm 5 to 1000 lb - 700 ohm
EXCITATION:	5 Vdc
SAFE OVERLOAD:	50% Over Capacity
CABLE:	
LPM 510A -	4 Conductor Teflon SS Braided Shielded Cable, 5 Ft with Temperature Compensation Board on Cable
LPM 510B -	4 Conductor Teflon SS Braided Shielded Cable, 5 Ft
WIRING CODES:	
LPM 510A -	Red +Excitation Black -Excitation Green -Signal White +Signal
LPM 510B -	Red +Excitation Black -Excitation Green +Signal White -Signal



AVAILABLE RANGES	D1"	D2"	H"
1000 g; 1000 lb	.38	.09	.13
10; 25; 50 lb	.38	.09	.13
100; 250 lb	.50	.12	.15
500; 1000 lb	.75	.20	.25

LPM 510A

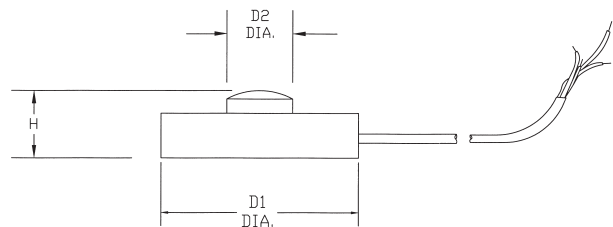

# LPM 510A/LPM 510B - SUBMINIATURE LOAD CELLS

LPM 510B 5 - 50 lbs

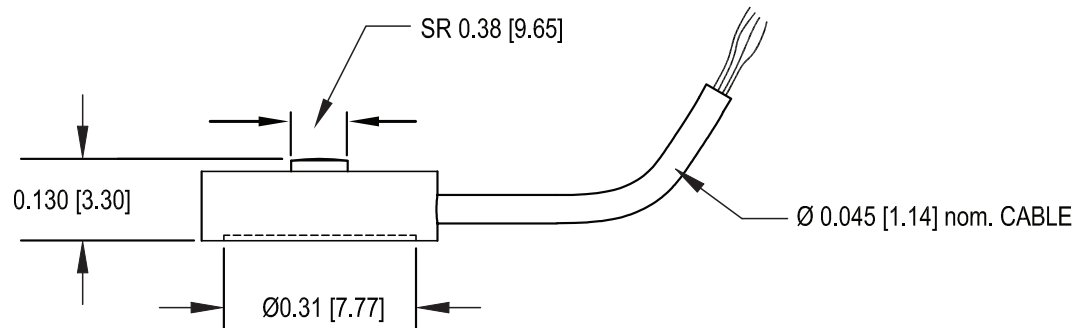

LPM 510B 100 - 250 lbs

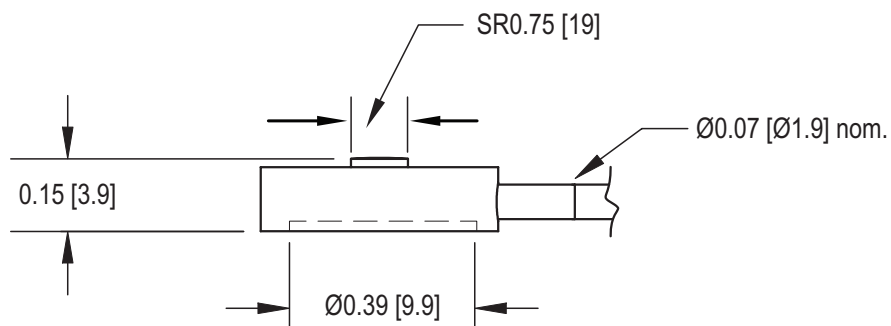

CAPACITIES	
LB	N
5	22.2
10	44.5
25	111
50	222
100	445
150	667
250	1112
500	2224
1000	4448

LPM 510B 500 - 1000 lbs

