

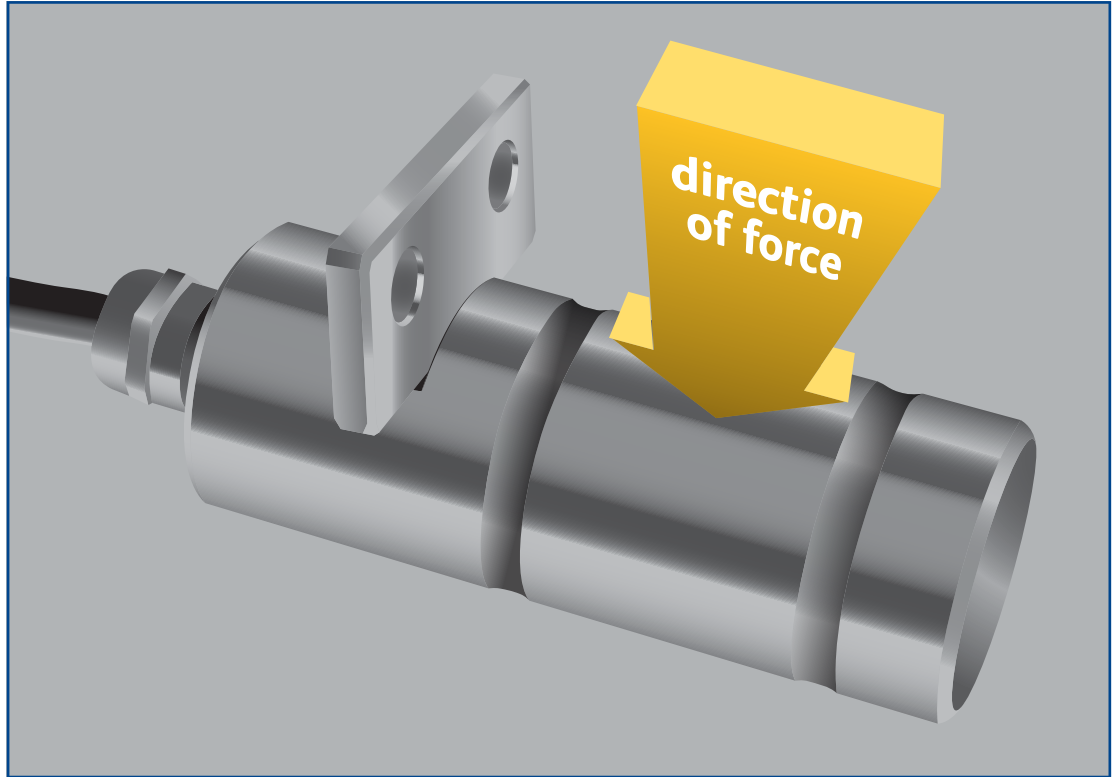

load pin



The Straightpoint range of Load Measurement Pins (LMP's) are designed for use in custom or bespoke applications where more common, traditional load cells are not applicable. Load pins commonly replace for example, Sheave pins and Clevis pins to provide an integrated solution.

Often a customised solution they are manufactured from high tensile stainless steel and are normally supplied complete with an anti-rotation plate as a cabled or wireless solution.

Built to withstand the harshest environments in industries such as marine and offshore oil and gas they are suitable for use in exposed situations and can be supplied to withstand immersion in seawater to extreme depths.

Our Load Pins are typically connected to our Handheld plus or may be supplied with a vast array of output formats to include mV/V, RS-422, RS-485, utilizing the ASCII, MODBUS TRU and CAN-BUS protocols or an analogue output such as 4-20mA for PLC integration. They are also supplied with a 10 meter cable as standard however usable cable length varies greatly with lengths available to 5,000 feet (1500 meters) depending on output format.

Please email your enquiry to: sales@straightpoint.com.



Requires connection to our Handheld plus (HHP), our Desktop Controller data logging software (DCP10M) or our External Amplifier range (SA-3420) that can be configured to provide outputs such as 4-20mA, 0-10v, 0-5v for PLC or data logger integration.

Please note: Please advise cable configuration on order - Radial or Axial Pin exit.
If you require a Load Pin to a particular size and design, download our Load Pin questionnaire and return, POA.

Applications:

- Marine tankers, offshore platforms
- Elevator and floor conveyor testing and certification
- Bearing blocks, pivots and shackles
- Cable laying equipment
- Rope, chain, and brake anchors
- Bridge support cables
- Mooring lines
- Pulleys and sheaves
- Crane cables
- Hoisting gear
- Winches
- Design validated by F.E.A.

imperial specifications

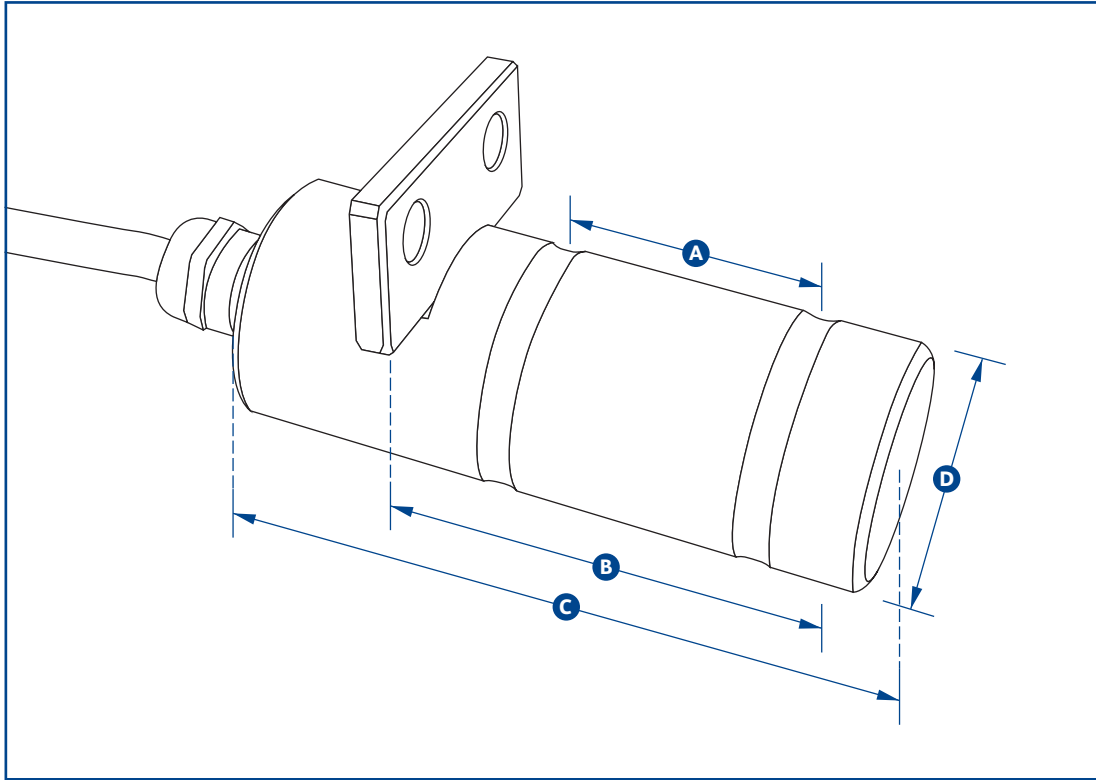

load pin

Part Number	LP500KGU	LP1TU	LP2.5TU	LP3.5TU	LP6.5TU	LP15TU	LP25TU	LP50TU	LP100TU	LP250TU	LP500TU	LP750TU	LP1000TU	LP1500TU
Capacity	1100lb	2200lb	5500lb	7700lb	14000lb	33000lb	55000lb	110000lb	220000lb	550000lb	1100000lb	1650000lb	2200000lb	3300000lb
Resolution	0.5lb	1lb	2lb	2lb	5lb	5lb	10lb	20lb	100lb	200lb	500lb	500lb	1000lb	1000lb
Units	kgs, tonnes													
Weight	0.4lb	0.5lb	0.9lb	1.3lb	2.6lb	5lb	10.3lb	18lb	24lb	64lb	172lb	319lb	603lb	854lb
Safety Factor	300 % of WLL													
Operating Temp	-20°C to +70°C / -4°F to 158°F													
Accuracy	±1 % of applied load													
Protection	IP67 / NEMA 6 (IP68 / NEMA 6P available as an option)													
Dimension A	0.94	1.38	1.77	1.97	2.48	2.95	3.50	4.02	4.33	5.12	8.86	11.61	14.17	16.93
Dimension B	1.42	1.93	2.76	2.95	3.74	4.49	5.98	7.01	7.48	8.66	14.57	19.69	24.09	28.78
Dimension C	2.76	3.15	3.94	4.13	4.92	5.91	7.68	8.86	9.06	11.81	17.32	23.23	28.03	32.76
Dimension D	0.79	0.79	0.98	1.18	1.57	1.97	2.48	2.95	3.46	4.92	6.69	7.87	9.84	10.83

Please note: If you require a load pin to a particular size and design, download our load pin questionnaire and return (price on application).
Wireless Load Pins available (price on application).

